

PREPARATION

IMPORTANT:

Familiarize yourself with your new iClean PRO.

Your iClean PRO kit includes:

- iClean PRO device
- USB charging cord
- Instruction sheet
- Gift box

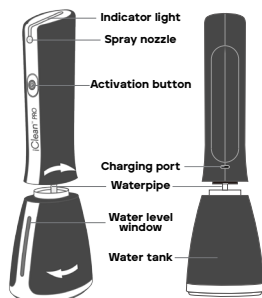

CHARGE

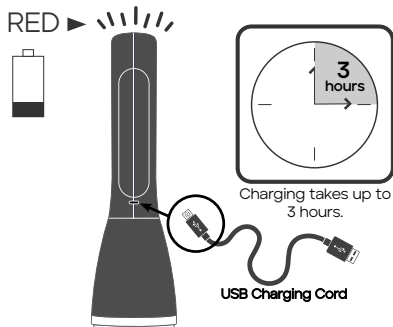

- The charging port is located on the back of the iClean PRO.
- Connect the USB charging cord to the device.
- Plug the other end of the charging cord into a USB outlet or through a USB power adapter (not included) then into a standard electrical outlet.
- A **slowly flashing red light** on top indicates charging is taking place.
- Charging is complete when a **blue light** on top flashes.
- Unplug the charging cord from the outlet and disconnect the charger from the iClean.

Note: If iClean PRO does not operate when activation button is pressed, the iClean PRO needs to be recharged. iClean PRO will not operate during the charging process.

FILL

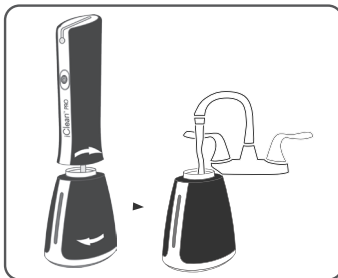

- Turn reservoir on base counter-clockwise and remove from iClean PRO.
- Fill reservoir with cold tap water **ONLY**.
- Reattach reservoir to iClean PRO and turn clockwise to fasten tightly.
- Fill with tap water **ONLY**.
- Do **NOT** add chemicals or soap.
- Do not submerge under water.

USE

INDICATORS

- When activation button is pressed, a **continuous blue light** on top indicates iClean PRO is producing aqueous ozone.
- A **continuous red light** on top indicates reservoir is empty.

CLEAN

- Press activation button on front of iClean PRO to wet surface to be cleaned.
- Wipe surface dry with a cotton, microfiber, or paper textile.

Note: no need to wipe completely dry – residual water will evaporate without streaking.

SANITIZE

- Kill germs only on hard, non-porous surfaces.
- Clean surface with the iClean PRO.
- Press button and continuously spray surface with aqueous ozone.
- Wipe surface dry with any clean cloth.

CARE

RECHARGING

- It is not necessary to drain battery completely before recharging.
- **ONLY** use charger supplied with iClean mini kit.

MAINTENANCE

To maintain consistent performance, follow these care instructions.

- When iClean PRO has not been used for more than 5 days, fill reservoir completely, press activation button, and spray until reservoir is empty. Then refill reservoir and iClean PRO is ready for use again.
- Use only attachments and replacement parts sold or recommended by manufacturer.
- iClean PRO is **NOT** dishwasher safe.
- iClean PRO is not a toy. Supervision required when children present.

STORAGE

- Empty water from reservoir.
- Store upright at room temperature.
- Do not dispose of device or battery in household trash. Dispose of properly. Contact Tersano with questions.
- Store upright and indoors above 40°.

EPA Est. No.: 93508-CHN-1

Product may vary slightly from illustrations enclosed in this use and care guide.

PRODUCT DESCRIPTION

iClean PRO	Aqueous ozone	Colour	Dark blue
Model	LQFC300	Water Quality	Clean tap water
Battery	7.4V Li-ion	Water Temperature	4-40°C
USB-C Charging Cable	Connect to USB outlet/adaptor 5VDC, ≥1A	Net Weight	364g
Dimension	100 x 80 x 270mm	Tank Capacity	350ml
Charging Time	Up to 3 hours	O ₃ Water Concentration	up to 2.5 ppm

CAUTION

- For first time usage, charge for 4 hours and then spray at least one tank of water to activate the unit in order to achieve the normal concentration value of O₃ water.
- Do not spray directly into the eyes.
- Avoid flushing the unit with water.

US and International Patents and Patent Pending. lotus[®] and Tersano[®] are trademarks of Tersano Inc.

REPLACEMENT SAO[®] CARTRIDGES

For optimum cleaning and sanitizing performance, change cartridge seasonally (no less than every three months).
One cartridge lasts over 1,000 sprays.

CHANGING YOUR ICLEAN[®] PRO CARTRIDGE

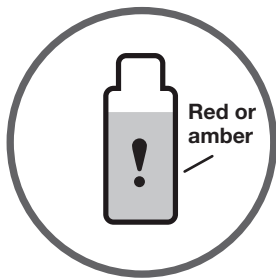

1. When cartridge window changes orange to red or purple to amber, time to replace.

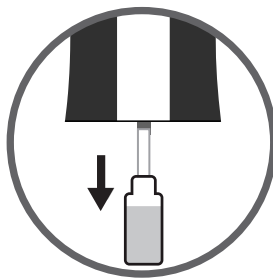

2. Open reservoir, pull down old cartridge to disengage.

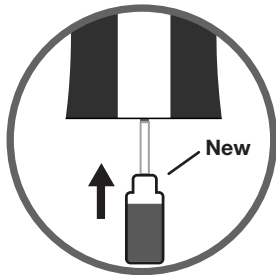

3. Remove protective tube from new replacement cartridge and slide onto long hose attached to notch in iClean PRO.



4. Replace reservoir.



Replace cartridge every
3 months (seasonally).

Product may vary slightly from illustrations enclosed in this use and care guide.