

2

1

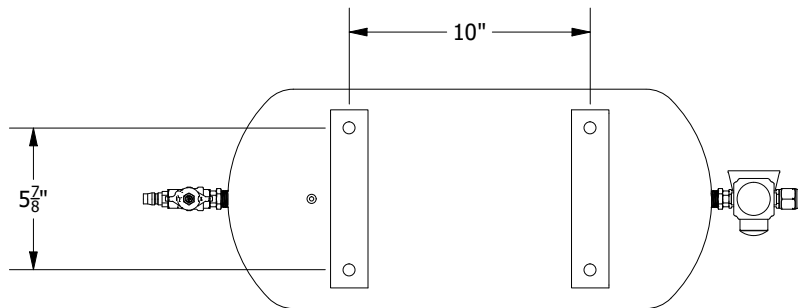
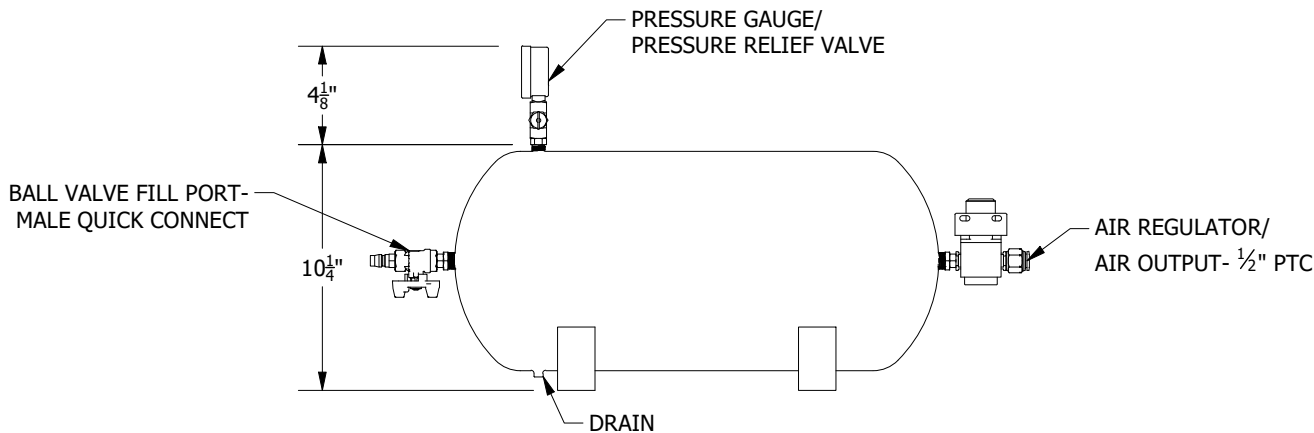
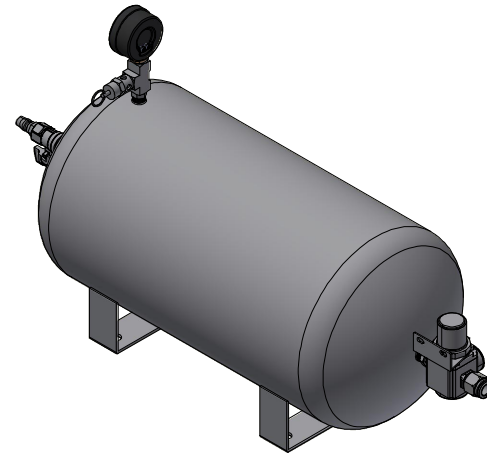
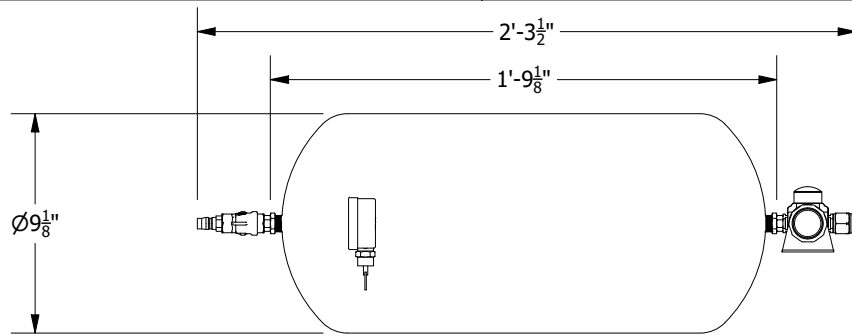

NOTE: THIS TANK IS RECOMMENDED TO BE USED WITH A MAX. OF 4 CASTERS. THE 5 GALLON TANK HAS CAPACITY FOR 4 CYCLES FOR 4 CASTERS, 2 CYCLES FOR 6 CASTERS, AND 1 CYCLE FOR 8 CASTERS.

NOTE: ACTUAL PARTS AND DIMENSIONS MAY VARY SLIGHTLY FROM THIS DRAWING.

THIS DRAWING REPRESENTS VISUAL CONCEPTS AND CONSTRUCTION SUGGESTIONS ONLY. PLEASE REVIEW CONSTRUCTION METHODS AND MATERIAL DETAILS FOR SUITABILITY. FINAL APPROVAL IS REQUIRED BEFORE CONSTRUCTION CAN BEGIN. PLEASE CONTACT ROSE BRAND TO DISCUSS ALTERATIONS TO THE PROJECT.



# ROSE BRAND

PO BOX 1536 SECAUCUS, NJ 07096  
800-223-1624 ROSEBRAND.COM

ALL DIMENSIONS IN INCHES (IN) UNLESS STATED OTHERWISE

**TOLERANCES:**

0.X	= ± 0.2	X/X	= ± 1/16
0.OX	= ± 0.01	<	= ± 1/2°
0.00X	= ± 0.005		
0.000X	= ± 0.0005		

CLIENT	PROJECT		
TITLE			
<b>CAST0116- 5Gal Air Tank for Pneumatic Lift Triple Swivel Casters</b>			
SIZE	SCALE	DRAWN BY	DATE
A	1-1/2"=1'-0"	CWO	1/23/2023
		REV	

2

1