

UNITRACK TRACK SYSTEM

The UNITRACK system which is central to the Triple E product range, is the market leader due to its robustness, versatility and reliability.

With its unique fabricated 'I' beam construction forming a very solid running surface, ball raced runners and nylon pulley sheaves, the system is smooth, quiet and trouble free.

The full range of products detailed on the following pages is testament to our ongoing programme of developing new products to meet customers needs, and improving the old ones where possible.

With the addition of TRAC-DRIVE for manual or motorised winch operation, UNITRACK will meet all the requirements of major venues, shows and any environment where heavy duty reliable tracking is essential.

All parts for the system are illustrated in this section, but for a quotation for a specific project or installation, please contact our sales department.

Track Sections

TRA 01	250mm Straight track section
TRA 02	500mm Straight track section
TRA 03	1 metre Straight track section
TRA 04	2 metre Straight track section
TRA 05	Joint set (4 spigots, 1 joint bolt with nut and 2 washers)

Runners

TRA 06	2 wheeled runner , for straight track. The runner may be added or removed at any point along the track whether or not the system is corded, by removing the keeper bar. For standard curtains the runners should be spaced 300mm apart. Each runner has a SWL of 25Kg.
TRA 06c	4 wheeled runner , for curved track. The four wheels ensure that the runner cannot stick or jam. Each runner has a SWL of 25Kg.
TRA 06r	Rearfold runner , as TRA 06 but with rearfold accessory fitted. These will cause the curtain to stack at the rear or offstage end of the curtain instead of the centre. It is of particular use on painted cloths where the image is not lost as the curtain folds. Each runner has a SWL of 25Kg.
TRA 07	Master runner , used for the leading edge of curtains and to clamp the cord on corded systems. The spacing between the two curtain loops on the master runner is 55mm. Each runner has a SWL of 50Kg.
TRA 07s	Master runner with adjustable rope clamp , for use on single tracks when used with part number TRA 31. Each runner has a SWL of 50Kg.
TRA 07a	Overlap arm , may be added to master runners on single tracks to create an overlap.
TRA 08	Rearfold accessory , may be retro-fitted to TRA 06 to make TRA 06r.

Scenery Carriers

TRA 28	Scenery carrier , used to carry items of varying thickness from 6mm to 60mm. It pivots in all directions allowing the flattage to be attached to the carrier at working height, pivoting as the track is flown. Each carrier has a SWL of 50Kg.
TRA 28hd	Heavy Duty Scenery Carrier . Capable of carrying a much heavier load than the standard Scenery Carrier, with a SWL of 100Kg.
TRA 28a	Scenery carrier (top only) . Used where odd items of scenery are to be suspended, the centre hole in the carrier can accommodate 12mm studding or bolts. Each carrier has a SWL of 50Kg.
TRA 28b	Scenery Carrier (bottom only) Can be retro-fitted to TRA28a / 28hd for full scenery carrying capability.

Pulleys

TRA 09	Head pulley , used on straight track system to divert the cord down to the floor. The rearfold system uses this pulley.
TRA 10	Return pulley , Used at the opposite end of straight track systems from the TRA 09.
TRA 11	Foot stirrup , used on flown or movable track systems. It can be tensioned by placing a foot into the stirrup and pressing it to the floor. Alternatively holes are provided in the base so that it can be screwed to the floor.
TRA 12	Adjustable floor pulley , this can be weighted or screwed to the floor and the pulley may be altered in height and clamped to adjust the tension of the operating cord.
TRA 31	Single track pulley set . A set of head and return pulleys used on a single track. They can be purchased separately as TRA 31h and TRA 31r. When used in conjunction with TRA 07s and TRA 07a, a centre overlap can be achieved. When used with scenery carriers, the scenery will butt together in the centre.

TRA04

TRA03

TRA02

TRA01

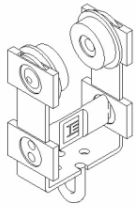
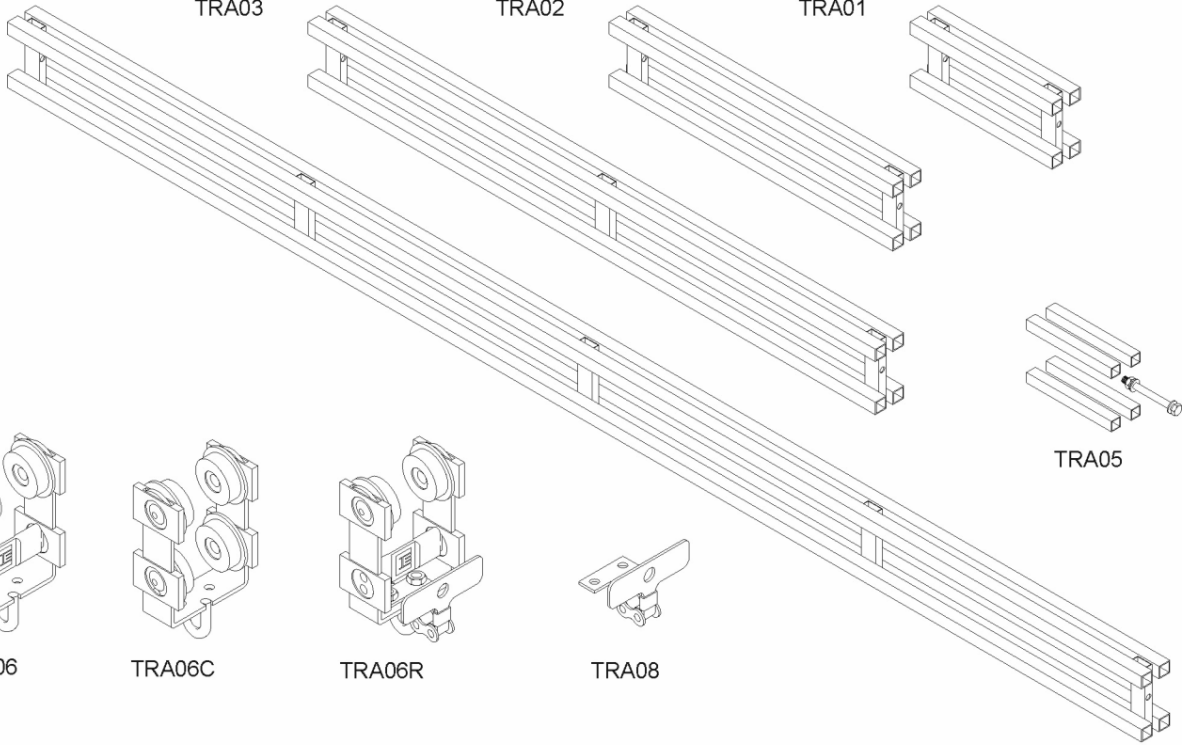

TRA06

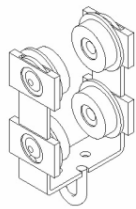

TRA06C

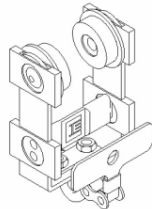

TRA06R

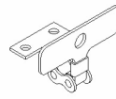

TRA08

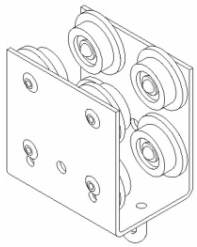

TRA07

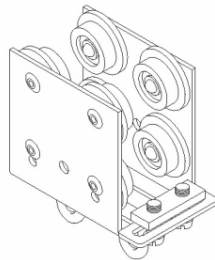

TRA07S

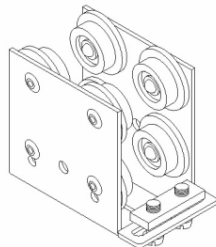

TRA28A

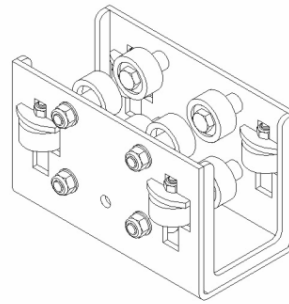

TRA28A HD

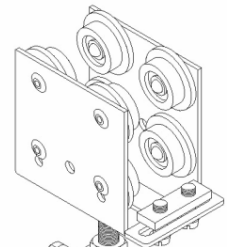

TRA28

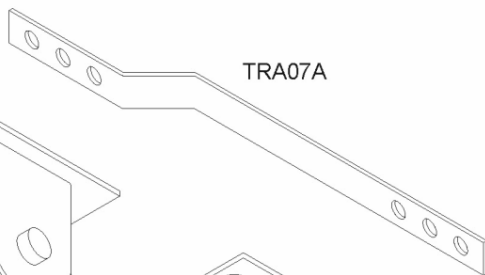

TRA07A

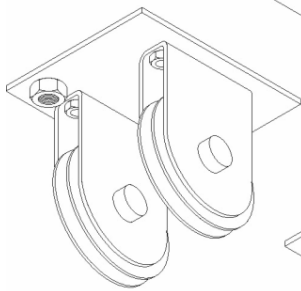

TRA09

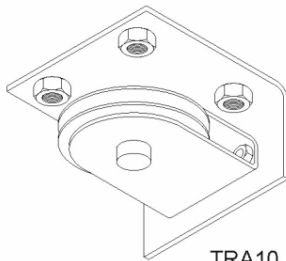

TRA10

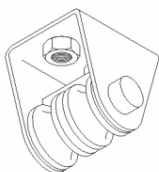

TRA31H

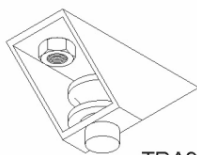

TRA31R

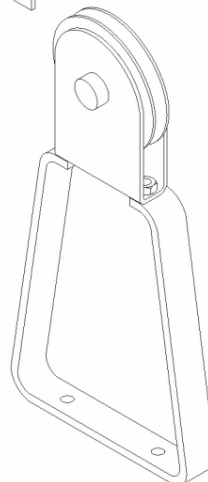

TRA11

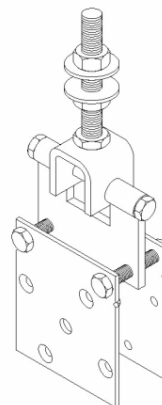

TRA28B

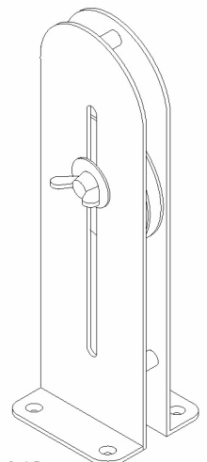

TRA12

Suspensions

TRA 13	Girder clamp , used to suspend the track from I beams. They will adjust to fit any size of beam, and are used with studding TRA18. SWL Data available on application.
TRA 14N	48 - 62mm hook clamp , used for attaching the track to any size tube, truss etc. between 48 and 62mm diameter. Tested to 70Kg SWL.
TRA 15	Deadline fixings , used for suspending tracks from rope or wire rope. Tested to 150Kg safe working load.
TRA 16	Wall bracket set , used to attach the track to a wall or vertical surface, used with studding TRA 18. Tested to 100Kg safe working load at 200mm reach.
TRA 17	Offset plate , used with hook clamps TRA 14N, when an overlap track is suspended from a single pipe or tube. They ensure the track hangs centrally to the tube.
TRA 18	Studding set , a 150mm length of M12 studding supplied with four nuts and washers. Studding can be supplied in longer lengths if required.

Accessories

TRA 24	Endstop , used for the ends of all tracks to anchor the trailing edge of the curtains.
TRA 24s	Flat endstop , for use on scenery tracks, where there is no curtain to anchor.
TRA 25	Line pickup , used on straight tracks on the return side of the operating cord to prevent slack line from drooping into vision. Suggested fitting at 2.5m centres.
TRA 26	Overlap clip set , used on straight and curved track to maintain 80mm centres and keep the tracks rigid where they overlap.
TRA 27	Cord / Handline , 8 plait, 8mm diameter pre stretched matt black polyester cord used to operate the track systems.

Curved track sections

TRC 10 / 90	Standard curved track section, 1 metre radius, 90 degrees
TRC 15 / 90	Standard curved track section, 1.5 metre radius, 90 degrees
TRC 20 / 90	Standard curved track section, 2 metre radius 90 degrees
TRC 30 / 90	Standard curved track section, 3 metre radius 90 degrees
	Curved track sections also require joint set TRA05
	Other radii or lengths are available, made to order.

Curved track fittings

TRA 19	Curve cord guide , bolts to the top of the track and guides the operating cord around the top of the track system. They should be positioned 500mm apart on the curves and at 2m centres on the straight track
TRA 20	Curve master runner , the arm attaches to the operating cord above the track and is guided through the curve cord guides (TRA 19). SWL 50kg
TRA20hd	Heavy Duty curve master runner . As TRA20, but for use on longer tracks.
TRA 21	Curve head pulley . Redesigned tin 1996, can now be used to divert the operating cord either upwards to a motor, or down to the floor pulley(TRA 11 or TRA 12).
TRA 22	Curve return pulley , improved in 1996, diverts the operating cord above the track back towards the head pulley (TRA 21).
TRA 23	Curve suspension bracket .. It is used with other suspensions (TRA 13, 14N, 15, 16 & 18). The top holes work as an offset plate on curve tracks that overlap and are suspended from a single tube or pipe.

